

# CompTIA

## Exam Questions 220-1201

CompTIA A+ Certification Exam: Core 1



### NEW QUESTION 1

- (Topic 1)

Which of the following best represents the purpose of NFC?

- A. Wired connections between several devices
- B. Short-distance wireless connections between two devices
- C. Wireless connections between multiple devices at once
- D. Direct connection of two computers for file sharing

**Answer: B**

#### Explanation:

Comprehensive and Detailed Explanation From Exact Extract:

NFC (Near-Field Communication) is a subset of RFID technology designed for very short- range wireless communication, typically within a few centimeters. It is primarily used for contactless transactions, like mobile payments, and can also support peer-to-peer data exchanges. NFC operates at 13.56 MHz and enables devices to communicate when placed near each other.

Reference: "CompTIA A+ Complete Study Guide" by Quentin Docter – Chapter 7, "Wireless and SOHO Networks", page 400.

### NEW QUESTION 2

- (Topic 1)

A network administrator must ensure that a printer will still be assigned a specific IP address even if all addresses are depleted. Which of the following network configuration concepts is this describing?

- A. VLAN
- B. Lease
- C. Reservation
- D. Exclusion

**Answer: C**

#### Explanation:

Comprehensive and Detailed Explanation From Exact Extract:

A DHCP reservation binds a specific MAC address to an IP address so the device always receives the same IP from the DHCP server. This ensures network devices like printers maintain consistent connectivity and availability even when the IP pool is low.

Reference: "CompTIA A+ Complete Study Guide" by Quentin Docter – Chapter 18, page 1252.

### NEW QUESTION 3

- (Topic 1)

A technician is working on a RAID 1 array that is apparently degraded. The technician verifies the RAM and power are both operating as expected. Which of the following can the technician do to further isolate the issue?

- A. Perform individual drive diagnostics.
- B. Run the chkdsk /i command.
- C. Rebuild the RAID array.
- D. Reconfigure the array as RAID 0.

**Answer: A**

#### Explanation:

Comprehensive and Detailed In-Depth Explanation:

A degraded RAID 1 array usually means one of the drives has failed or is failing. The correct next step is to run diagnostics on each drive to identify the faulty one. RAID 1 uses mirroring, so one good drive should still contain all the data.

? Option B: chkdsk checks file system integrity, not hardware drive health.

? Option C: Rebuilding should only occur after identifying and replacing a faulty drive.

? Option D: RAID 0 offers no redundancy and would destroy data in this context. CompTIA A+ Core 1 Exam Objective Reference:

? Objective 3.5: Given a scenario, troubleshoot problems related to storage devices.

### NEW QUESTION 4

- (Topic 1)

Several storms cause mission-critical servers to go offline unexpectedly. A server also goes offline suddenly due to hardware failure. Upon assessment, the company purchases new UPSs to condition power and allow the OSs to shut down gracefully in the event of a power failure. However, the UPSs are delayed due to supply chain issues. Which of the following can balance a cost-effective solution with uptime requirements?

- A. Purchasing backup generators
- B. Increasing input voltage
- C. Installing redundant PSUs
- D. Activating a hot site

**Answer: C**

#### Explanation:

\* C. Installing redundant PSUs (Power Supply Units):

Redundant PSUs provide fault tolerance by ensuring that if one power supply fails, another will take over seamlessly.

This is a cost-effective way to increase uptime while waiting for the UPSs to arrive. Incorrect Options:

\* A. Purchasing backup generators: Generators are costly and are typically used for long-term outages, not as an immediate or cost-effective solution.

\* B. Increasing input voltage: This is not a practical solution to hardware failures or power issues.

\* D. Activating a hot site: A hot site is an expensive, fully operational backup facility that would not be a cost-effective solution for this scenario.

Key Takeaway: Installing redundant PSUs is a cost-effective way to balance uptime requirements in case of power or hardware failure.  
Reference: CompTIA A+ Core 1 Exam Objectives (220-1201), Domain 5.3 – Power-related troubleshooting.

#### NEW QUESTION 5

- (Topic 1)

Which of the following provides electricity to devices through network cables?

- A. Edge router
- B. PoE switch
- C. Access point
- D. Patch panel

**Answer: B**

#### Explanation:

Comprehensive and Detailed Explanation From Exact Extract:

A PoE (Power over Ethernet) switch transmits both data and electrical power over Ethernet cables to devices like wireless access points or VoIP phones. This is especially useful in areas where separate power sources are not available.

Reference: "CompTIA A+ Complete Study Guide" by Quentin Docter – Chapter 5, pages 319–321.

#### NEW QUESTION 6

- (Topic 1)

Which of the following utilizes specialized ports on a laptop to expand the local connection options?

- A. NFC adapter
- B. Docking station
- C. Port replicator
- D. USB dongle

**Answer: B**

#### Explanation:

Comprehensive and Detailed In-Depth Explanation:

A docking station connects to a laptop via a proprietary port or USB-C/Thunderbolt, providing access to multiple additional ports (USB, Ethernet, video, audio, etc.). It allows users to transform a laptop into a full desktop workstation.

? Option A (NFC adapter): Used for short-range communication, not port expansion.

? Option C (Port replicator): Similar to a dock but usually less powerful and often lacks charging or video output.

? Option D (USB dongle): Adds a single function (like Wi-Fi or storage), not full port expansion.

CompTIA A+ Core 1 Exam Objective Reference:

? Objective 1.4: Given a scenario, configure settings and use cases for laptops and mobile devices.

=====

#### NEW QUESTION 7

- (Topic 1)

Which of the following should a technician use to terminate a Cat 6 cable to a patch panel?

- A. Punchdown tool
- B. Crimper
- C. Toner probe
- D. Network tap

**Answer: A**

#### Explanation:

Comprehensive and Detailed Explanation From Exact Extract:

A punchdown tool is specifically used to insert wires into a punchdown block in patch panels, which is typical for Cat 6 and similar cabling. It ensures a secure and correct connection by pushing the wire into a metal groove that slices the insulation.

Reference: "CompTIA A+ Certification All-in-One Exam Guide" by Mike Meyers – Chapter 18, page 758.

#### NEW QUESTION 8

- (Topic 1)

A technician is experimenting with network configurations and has connected two laptops to an unmanaged switch. The technician configured one of the laptops with a static IP address of 192.168.1.1 and the other with a static IP address of 192.168.2.2. The laptops are not communicating with each other. Which of the following is the most likely explanation for this issue?

- A. The technician needs to use a hub instead of a switch.
- B. The wireless NICs are malfunctioning.
- C. PoE interferes with intersubnet communication.
- D. The laptops do not have access to a router.

**Answer: D**

#### NEW QUESTION 9

- (Topic 1)

A salesperson is unable to use a personal device to access emails and calendar features at a client site but was able to use the device while at the office. Which of the following policies has been enforced on the salesperson's mobile device?

- A. MOW

- B. MAN
- C. MFA
- D. MAM

**Answer:** D

**Explanation:**

Mobile Application Management (MAM) enforces policies restricting access to apps and services based on location, ensuring security at external sites.

Why Not A (MOW): "Mobile Only Workplace" (MOW) is not a recognized term in this context.

Why Not B (MAN): Metropolitan Area Network (MAN) is unrelated to mobile device policies. Why Not C (MFA): Multi-Factor Authentication secures user accounts but does not enforce app restrictions.

CompTIA A+ Exam Reference: Core 2 (220-1102), Section 2.7, mobile device security policies.

**NEW QUESTION 10**

- (Topic 1)

A company uses vital legacy software that does not run in the current OS version Which of the following will best support the software while keeping the OS current?

- A. Shared resources
- B. System sandbox
- C. Test development
- D. Application visualization

**Answer:** D

**Explanation:**

Application virtualization allows legacy software to run in a virtualized environment while the operating system remains current. It isolates the application from the OS, ensuring compatibility without downgrading the OS.

Why Not A (Shared resources): This relates to resource sharing, not application compatibility.

Why Not B (System sandbox): Sandboxes isolate applications for security testing, not compatibility.

Why Not C (Test development): Test environments are used for development, not running legacy applications.

CompTIA A+ Exam Reference: Core 1 (220-1201), Section 4.2, virtualization concepts.

**NEW QUESTION 10**

- (Topic 1)

A technician wants to monitor network statistics for devices communicating with one another on the local subnet Which of the following devices should the technician install.

- A. Managed switch
- B. Router
- C. Access point
- D. Firewall

**Answer:** A

**Explanation:**

A managed switch provides advanced features such as traffic monitoring and VLAN configuration, allowing a technician to view network statistics for devices on the local subnet.

Why Not B (Router): A router connects different networks and directs traffic between them but does not provide detailed subnet-level statistics.

Why Not C (Access point): Access points provide wireless connectivity but lack traffic monitoring features.

Why Not D (Firewall): A firewall filters traffic but is not used for monitoring detailed statistics on a local subnet.

CompTIA A+ Exam Reference: Core 1 (220-1201), Section 2.6, network monitoring tools.

**NEW QUESTION 11**

- (Topic 1)

A technician is having issues replacing a laptop's wireless card because the cover seems to be stuck Which of the following should the technician do next to troubleshoot this issued

- A. Check the product manual for the procedure
- B. Use a pry tool to force the cover open
- C. Insert the wireless card into the M.2 slot
- D. Try to move the cover by sliding it in all directions.

**Answer:** A

**Explanation:**

\* A. Check the product manual for the procedure:

When hardware is not easily accessible, always consult the product manual for proper disassembly procedures. Forcing the cover can damage the laptop or void the warranty. Product manuals often provide step-by-step instructions for safely accessing internal components.

Incorrect Options:

\* B. Use a pry tool to force the cover open: Forcing the cover can cause physical damage to the device.

\* C. Insert the wireless card into the M.2 slot: This step cannot be performed until the cover is properly removed.

\* D. Try to move the cover by sliding it in all directions: Randomly sliding the cover can cause damage if the correct removal method is not followed.

Key Takeaway: Always refer to the product manual to ensure safe and proper disassembly of laptop components.

Reference: CompTIA A+ Core 1 Exam Objectives (220-1201), Domain 4.1 – Best practices for laptop hardware installation.

**NEW QUESTION 16**

- (Topic 1)

A user brings a laptop to work every morning, correctly seats it in the docking station and then opens the laptop to begin work with no issues After the user left the

laptop at home during a two-week vacation the laptop is no longer working. Upon returning to the office, the user reports that the keyboard and display are no longer working. Which of the following should the technician ask the user to do first?

- A. Ensure the docking station is plugged in.
- B. Press and release the laptop power button.
- C. Plug the laptop in and let it charge overnight.
- D. Connect the laptop directly to the network.

**Answer: B**

**Explanation:**

Reasoning: Many docking stations provide power and functionality only when the laptop is properly powered on. If the laptop was powered off (e.g., during the vacation), docking it will not automatically turn it on. The technician should first ensure the laptop is powered on by pressing the power button.

This is a common troubleshooting step when laptops in docking stations appear non-functional.

Relevance to CompTIA A+ Core 1: This falls under Objective 5.2, which covers diagnosing and resolving common laptop and mobile device issues.

Why the Other Options Are Incorrect:

\* A. Ensure the docking station is plugged in:

While ensuring power to the docking station is important, the scenario specifies that the issue occurred after a vacation. The likelihood of the docking station losing power coincidentally during the vacation is low. Verifying the laptop's power state should be the first step.

\* C. Plug the laptop in and let it charge overnight:

There is no indication the laptop's battery is drained. While charging could resolve a dead battery, the user is more likely experiencing an issue where the laptop is powered off but docked, so charging overnight is not the best first step.

\* D. Connect the laptop directly to the network:

A network connection will not resolve the primary issue of the keyboard and display not working. Addressing the laptop's power state is a higher priority.

Practical Example:

If a user returns from a vacation and places a powered-off laptop into a docking station, it may not automatically power on. Pressing the power button ensures the laptop is operational and communicating with the docking station.

CompTIA A+ Exam Objective Alignment:

Objective 5.2: Troubleshooting common laptop issues, including power, display, and peripheral connectivity.

**NEW QUESTION 19**

- (Topic 1)

A new directive mandates the use of a security component to securely allow users to authenticate to systems, access sensitive data, and enter the office. The component must provide an additional factor of authentication alongside user accounts and cannot be something the user owns. Which of the following components best meets these requirements?

- A. Fingerprint reader
- B. Smart card
- C. Secure token
- D. NFC scanner

**Answer: B**

**Explanation:**

A smart card provides an additional factor of authentication by storing secure credentials, such as certificates, that cannot be guessed or replicated. It complements user accounts and is "something you have".

Why Not A (Fingerprint reader): This is "something you are", but the scenario specifically requires a physical token.

Why Not C (Secure token): Secure tokens are also valid but may not integrate as seamlessly into multi-factor authentication for physical and system access.

Why Not D (NFC scanner): An NFC scanner is a device and not a token itself; it reads cards or other credentials.

CompTIA A+ Exam Reference: Core 2 (220-1102), Section 2.5, access controls.

**NEW QUESTION 23**

- (Topic 1)

Which of the following tools is best to track where an Ethernet cable is patched?

- A. Crimper
- B. Punchdown tool
- C. Cable stripper
- D. Toner probe

**Answer: D**

**Explanation:**

Comprehensive and Detailed In-Depth Explanation:

A toner probe (also known as a tone generator and probe) is the best tool for tracing and identifying cables in a patch panel or wall jack. The tone generator sends a signal through the wire, and the probe helps locate the cable by detecting the tone.

? Option A (Crimper): Used to attach connectors (e.g., RJ-45), not for tracing cables.

? Option B (Punchdown tool): Used to terminate cables into patch panels or keystone jacks.

? Option C (Cable stripper): Used to remove insulation, not to trace cables. CompTIA A+ Core 1 Exam Objective Reference:

? Objective 5.1: Identify basic cable types, their connectors, and their features.

**NEW QUESTION 24**

- (Topic 1)

A technician needs to move a workstation to a different logical network segment. Which of the following technologies should the technician use?

- A. DHCP
- B. VLAN
- C. DNS
- D. VPN

**Answer:** B

**Explanation:**

Comprehensive and Detailed In-Depth Explanation:

AVLAN (Virtual LAN) is used to logically segment a network without requiring physical separation. It enables grouping devices based on function or department regardless of their physical location.

? Option A (DHCP): Assigns IP addresses dynamically but doesn't create network segments.

? Option C (DNS): Resolves domain names to IP addresses, not used for network segmentation.

? Option D (VPN): Provides secure remote access but does not relate to logical segmentation within a local network.

CompTIA A+ Core 1 Exam Objective Reference:

? Objective 2.3: Explain common logical networking concepts.

**NEW QUESTION 26**

- (Topic 1)

A help desk technician inspects a laptop keyboard because a single key has stopped working. The technician checks the keyboard for debris. Which of the following actions should the technician do next to troubleshoot the issue cost-effectively?

- A. Replace the keyboard.
- B. Replace the key switch
- C. Replace the circuit board.
- D. Replace the keycap

**Answer:** D

**Explanation:**

Comprehensive and Detailed Explanation From Exact Extract:

If only one key is not functioning and debris has been checked, replacing the individual keycap is the most cost-effective next step. It's a simple, low-cost option before considering more extensive repairs like replacing the entire keyboard.

Reference: "CompTIA A+ Complete Practice Tests" by Jeff T. Parker – Chapter 1, Question 10, page 8.

**NEW QUESTION 27**

- (Topic 1)

A management team is concerned about enterprise devices that do not have any controls in place. Which of the following should an administrator implement to address this concern?

- A. MDM
- B. MFA
- C. vpn
- D. SSL

**Answer:** A

**Explanation:**

Mobile Device Management (MDM) enables administrators to enforce controls on enterprise devices, such as restricting apps, ensuring compliance, and remotely managing security policies.

Why Not B (MFA): Multi-Factor Authentication secures user access but does not control device configurations.

Why Not C (VPN): VPN secures communication but does not enforce device controls. Why Not D (SSL): SSL secures data in transit but does not provide device management. CompTIA A+ Exam Reference: Core 2 (220-1102), Section 2.7, device management concepts.

**NEW QUESTION 29**

- (Topic 1)

Users working with large files back up the files to external hard drives. One user's files take longer to back up than other users' files. The user has tried backing up the files to other users' drives with the same results. Which of the following steps should the technician take first to correct this issue?

- A. Replace the hard drive's USB cable.
- B. Defragment the user's external hard drive.
- C. Update the storage drivers on the user's system.
- D. Instruct the user to compress the files.

**Answer:** B

**Explanation:**

If a hard drive is heavily fragmented, file read/write operations can take significantly longer, causing slow backup speeds. Defragmenting the drive organizes the data for more efficient access.

Why Not A (Replace the hard drive's USB cable): A faulty cable would typically cause disconnections or errors, not just slower speeds.

Why Not C (Update the storage drivers): This might help if the issue is with system drivers, but the described symptoms point to a fragmentation issue.

Why Not D (Compress the files): Compression reduces file size but does not address the root cause of the slow backups.

CompTIA A+ Exam Reference: Core 2 (220-1102), Section 3.1, storage troubleshooting.

**NEW QUESTION 34**

- (Topic 1)

A user experiences a random BSOD while using a computer, but the operating system recovers as expected. Which of the following symptoms would indicate the issue is related to RAM?

- A. Wrong BIOS configurations
- B. Continuous reboots
- C. Distended capacitors
- D. POST code beeps

Answer: D

**Explanation:**

\* D. POST Code Beeps:

During the Power-On Self-Test (POST), the BIOS performs checks on system hardware, including RAM. If the RAM is faulty, POST may produce a series of beep codes indicating memory issues.

These beep codes are often the first sign of RAM-related problems, especially if the BSOD occurs randomly.

Incorrect Options:

\* A. Wrong BIOS configurations: Incorrect BIOS settings may cause boot errors, but they are less likely to cause random BSODs.

\* B. Continuous reboots: Continuous reboots could result from multiple hardware or software issues but do not specifically point to RAM.

\* C. Distended capacitors: Faulty capacitors typically affect the motherboard, not the RAM. Key Takeaway: POST beep codes are a common diagnostic tool for identifying RAM-related issues.

Reference: CompTIA A+ Core 1 Exam Objectives (220-1201), Domain 5.2 –Troubleshooting RAM and motherboard issues.

**NEW QUESTION 38**

- (Topic 1)

Which of the following cloud models exclusively utilizes a local data center?

- A. Private
- B. Public
- C. Hybrid
- D. Community

Answer: A

**Explanation:**

Comprehensive and Detailed In-Depth Explanation:

A Private Cloud is operated solely for a single organization. It is hosted on-premises or in a dedicated off-site data center, giving the company full control over data, security, and compliance — often hosted in the organization's own local data center.

? Option B (Public): Hosted by third-party providers and shared by multiple clients.

? Option C (Hybrid): Combines private and public cloud resources.

? Option D (Community): Shared by several organizations with similar goals. CompTIA A+ Core 1 Exam Objective Reference:

? Objective 4.1: Compare and contrast cloud computing concepts.

=====

**NEW QUESTION 43**

- (Topic 1)

A user is experiencing multiple issues with an in-place upgrade of a laptop's operating system. The built-in camera is unresponsive, and the user is unable to pair the device with any Bluetooth accessories. Which of the following are most likely causing three issues? (Select two).

- A. Incorrect configuration of the settings
- B. OS and device version incompatibility
- C. Disabled settings following the upgrade
- D. Full storage
- E. Outdated drivers
- F. Corrupted registry entries

Answer: CE

**Explanation:**

Outdated drivers: Device functionality issues after an OS upgrade are often caused by incompatible or outdated drivers.

Disabled settings: Some features may be disabled during the upgrade process, requiring re-enablement.

Why Not A (Incorrect configuration): This is unlikely given the issues arose only after the upgrade.

Why Not B (OS and device incompatibility): Upgrades check for compatibility before installation.

Why Not D (Full storage): Storage issues typically prevent installation, not device functionality.

Why Not F (Corrupted registry entries): While possible, this is less common than the selected answers.

CompTIA A+ Exam Reference: Core 1 (220-1201), Section 3.5, troubleshooting OS upgrades.

**NEW QUESTION 44**

- (Topic 1)

Which of the following is the best to use when testing a file for potential malware?

- A. Multitenancy
- B. Test development
- C. Cross-platform virtualization
- D. Sandbox

Answer: D

**Explanation:**

Comprehensive and Detailed Explanation From Exact Extract:

A sandbox is a secure, isolated environment used to test potentially harmful software or code. It prevents the software from affecting the main system, allowing safe malware testing. This method is standard in cybersecurity best practices.

Reference: "CompTIA A+ Certification All-in-One Exam Guide" by Mike Meyers – Chapter 28, page 1230.

**NEW QUESTION 45**

- (Topic 1)

Which of the following cable types can be used to transfer data and video?

- A. USB-C
- B. HDMI
- C. DisplayPort
- D. VGA

**Answer:** A

**Explanation:**

Comprehensive and Detailed In-Depth Explanation:

USB-C is a versatile connector capable of transmitting data, video, audio, and power. With standards like DisplayPort over USB-C or Thunderbolt 3/4, it can be used for external displays, file transfers, charging, and more — all through one cable.

? Option B (HDMI): Supports video and audio but not general data transfer.

? Option C (DisplayPort): Similar to HDMI — supports video/audio but not general file transfer.

? Option D (VGA): Legacy analog video only — no data or audio support. CompTIA A+ Core 1 Exam Objective Reference:

? Objective 3.1: Identify common connector types.

**NEW QUESTION 46**

- (Topic 1)

A technician recently updated the firmware on a dual-BIOS motherboard. Following the update, the system has been stuck in a boot loop and cannot start an OS from any internal or external device. The technician cannot access the UEFI menu either. Which of the following should the technician do next?

- A. Enable the secondary configuration.
- B. Downgrade the firmware via USB.
- C. Start a warranty repair of the motherboard.
- D. Reapply thermal paste to the CPU.

**Answer:** A

**Explanation:**

Comprehensive and Detailed In-Depth Explanation:

Dual-BIOS motherboards contain two firmware chips. If the primary BIOS becomes corrupted, the system can failover to the secondary BIOS. Most boards allow manual enabling of the secondary BIOS via a physical switch or jumper.

? Option B: Downgrading firmware may not be possible if the system won't POST or access UEFI.

? Option C: Not necessary until both BIOS chips are non-functional.

? Option D: Thermal paste affects heat dissipation, not BIOS/boot behavior. CompTIA A+ Core 1 Exam Objective Reference:

? Objective 3.5: Given a scenario, troubleshoot problems related to motherboards, RAM, CPU, and power.

**NEW QUESTION 51**

- (Topic 1)

Users are complaining that the audio from a presenter is choppy and unintelligible. Which of the following is causing the issue?

- A. Webcam
- B. Digitizer
- C. Inverter
- D. Microphone

**Answer:** D

**Explanation:**

Choppy or unintelligible audio is typically caused by issues with the microphone, such as poor quality, hardware defects, or misconfiguration.

Why Not A (Webcam): The webcam handles video, not audio.

Why Not B (Digitizer): A digitizer relates to touchscreens, not audio. Why Not C (Inverter): Inverters manage power for displays, not audio.

CompTIA A+ Exam Reference: Core 1 (220-1201), Section 3.6, audio troubleshooting.

**NEW QUESTION 56**

- (Topic 1)

A technician needs to ensure all data communications on all network devices are encrypted when logging in to the console. Which of the following protocols should the technician enable?

- A. SSH
- B. LDAP
- C. FTPS
- D. SMTP

**Answer:** A

**Explanation:**

SSH (Secure Shell) encrypts data communications for secure remote login and management of network devices, ensuring all console connections are encrypted.

Why Not B (LDAP): LDAP is used for directory services and does not encrypt by default. Why Not C (FTPS): FTPS encrypts file transfers, not console communications.

Why Not D (SMTP): SMTP is used for email transmission, not for securing login sessions. CompTIA A+ Exam Reference: Core 1 (220-1201), Section 2.7, network security protocols.

**NEW QUESTION 57**

- (Topic 1)

Which of the following storage options would a technician most likely recommend to have large amounts of affordable capacity without concern for read times on a desktop computer?

- A. 750GB NVMe M.2 SSD
- B. 2x 1TB PCIe SSD in RAID 1
- C. 2TB SATA 3.5" 5,400rpm HDD
- D. 4TB SAS 2.5" 15,000rpm HDD

**Answer:** C

**Explanation:**

Comprehensive and Detailed In-Depth Explanation:

If performance is not a primary concern and the user requires large, cost-effective storage, a 2TB 5400rpm SATA HDD is ideal. It offers high capacity at a lower price point than SSDs and faster HDDs.

? Option A: NVMe drives offer exceptional speed but are significantly more expensive per GB and not necessary when read/write speed is not a concern.

? Option B: RAID 1 improves redundancy but cuts usable capacity in half and uses expensive SSDs.

? Option D: SAS drives are fast and reliable but are enterprise-grade and expensive — overkill for desktop use.

CompTIA A+ Core 1 Exam Objective Reference:

? Objective 1.3: Given a scenario, install and configure storage devices.

**NEW QUESTION 58**

- (Topic 1)

Which of the following connectors can be used to charge most modern mobile devices and may have the capacity to send data audio and video?

- A. Lightning
- B. USB-C
- C. MicroUSB
- D. MiniUSB

**Answer:** B

**Explanation:**

\* B. USB-C:

USB-C is a versatile connector that supports charging, high-speed data transfer, and the ability to send audio and video signals (e.g., DisplayPort over USB-C). It is used by most modern mobile devices and laptops because of its fast transfer speeds and power delivery capabilities.

Incorrect Options:

\* A. Lightning: Lightning is proprietary to Apple devices and does not natively support video output.

\* C. MicroUSB: MicroUSB is outdated and does not support video output.

\* D. MiniUSB: MiniUSB is an older standard and does not support modern features like video output or fast charging.

Key Takeaway: USB-C is the most versatile connector for charging and transferring data, audio, and video.

Reference: CompTIA A+ Core 1 Exam Objectives (220-1201), Domain 3.1 – Cable types and features.

**NEW QUESTION 62**

- (Topic 1)

A customer reports their tablet was recently dropped on the ground. The tablet has a small crack in one corner of the display, and it does not charge when plugged in. Which of the following should a technician do first?

- A. Perform a hard restart.
- B. Replace the battery
- C. Inspect the USB-C port for damage
- D. Run diagnostics on the digitizer

**Answer:** C

**Explanation:**

Comprehensive and Detailed Explanation From Exact Extract:

Physical damage from dropping a tablet may often affect ports or connectors. Before taking deeper diagnostic or replacement steps, it's important to visually inspect the USB-C charging port for damage or debris. If the port is damaged, charging issues can occur regardless of battery health.

Reference: "CompTIA A+ All-in-One Exam Guide, 11th Edition" by Mike Meyers – Chapter 25, "Maintaining and Securing Mobile Devices", page 879.

**NEW QUESTION 65**

- (Topic 1)

Which of the following is a benefit of using a VLAN?

- A. It minimizes collision domains.
- B. It provides private access to cloud resources.
- C. It increases network address space.
- D. It enables secure network segmentation.

**Answer:** D

**Explanation:**

A VLAN (Virtual Local Area Network) segments a physical network into separate logical networks, enhancing security by isolating traffic.

Why Not A (Minimizes collision domains): VLANs manage broadcast domains, not collision domains.

Why Not B (Provides private access to cloud resources): VLANs operate within a local network, not cloud-specific.

Why Not C (Increases network address space): VLANs do not affect address space. CompTIA A+ Exam Reference: Core 1 (220-1201), Section 2.6, VLAN concepts.

**NEW QUESTION 68**

- (Topic 1)

Which of the following display characteristics would be most important to ensure screen images appear the same as printed output?

- A. Color gamut
- B. Pixel density
- C. Refresh rate
- D. Resolution

**Answer:** A

**Explanation:**

Color gamut refers to the range of colors a display can accurately reproduce. For tasks like graphic design or photo editing, ensuring the screen's colors match the printed output is critical. Monitors with wide and accurate color gamuts (e.g., Adobe RGB) are preferred for these applications.

Option B (Pixel density): Incorrect. Pixel density affects image sharpness, not color accuracy.

Option C (Refresh rate): Incorrect. Refresh rate impacts motion smoothness but is unrelated to color matching.

Option D (Resolution): Incorrect. Resolution determines clarity and detail but does not influence color accuracy.

References:

CompTIA A+ Core 1 Objectives: 1.2 (Display types and characteristics)

**NEW QUESTION 71**

- (Topic 1)

Which of the following is a Bluetooth network an example of?

- A. PAN
- B. LAN
- C. WAN
- D. SAN

**Answer:** A

**Explanation:**

Comprehensive and Detailed Explanation From Exact Extract:

Bluetooth is a wireless technology designed for short-range communication between devices. It is a classic example of a Personal Area Network (PAN), which supports communication between devices like smartphones, headsets, keyboards, and mice within a few meters. PANs are smaller in scope compared to LANs or WANs.

Reference: "CompTIA A+ Complete Study Guide" by Quentin Docter – Chapter 5, "Networking Fundamentals", page 275.

**NEW QUESTION 75**

- (Topic 1)

Which of the following is an advantage of using VDI?

- A. Authentication is not required on a domain.
- B. Licensing costs are minimized.
- C. Less manual configuration is needed for each workstation.
- D. A virus is automatically contained locally.

**Answer:** C

**Explanation:**

Comprehensive and Detailed In-Depth Explanation:

Virtual Desktop Infrastructure (VDI) hosts desktop environments on centralized servers. This allows rapid deployment and consistent configuration across multiple users, minimizing manual setup and easing IT management.

? Option A: VDI still uses standard authentication methods.

? Option B: Licensing can actually be more expensive due to virtualization software and backend servers.

? Option D: VDI centralizes the desktop environment — viruses would affect the virtual session, not be "contained locally."

CompTIA A+ Core 1 Exam Objective Reference:

? Objective 4.1: Compare and contrast cloud computing concepts.

=====

**NEW QUESTION 80**

- (Topic 1)

Which of the forming connector types would best suit a company that experiences a large volume of internet traffic?

- A. USB 3.1
- B. Quad-shielded RG11 coax
- C. SATA3.0
- D. Unshielded plenum RJ45

**Answer:** B

**Explanation:**

RG11 coaxial cable with quad shielding is designed to handle large volumes of internet traffic, providing excellent resistance to interference and high bandwidth capacity.

Why Not A (USB 3.1): USB 3.1 is used for connecting peripherals, not for high-volume internet traffic.

Why Not C (SATA3.0): SATA is used for internal data storage connections, not for network traffic.

Why Not D (Unshielded plenum RJ45): While RJ45 cables are commonly used, unshielded cables are prone to interference and are not ideal for high-volume traffic.

CompTIA A+ Exam Reference: Core 1 (220-1201), Section 3.1, cable types and their characteristics.

**NEW QUESTION 84**

- (Topic 1)

A projector has been shutting down after 30 minutes of use, and it has a strange smell. The technician confirms the power source is not the cause of the issue. Which of the following steps should the technician take next to resolve this issue?

- A. Replace the bulb
- B. Check the projector configuration.
- C. Clean the filter
- D. Adjust the gamma settings.

**Answer: C**

**Explanation:**

Reasoning: Projectors have air filters that prevent dust from entering the internal components. A clogged filter can cause the projector to overheat, resulting in shutdowns and even strange smells due to overheating components. Cleaning the filter is a standard troubleshooting step when projectors exhibit overheating symptoms.

Why the Other Options Are Incorrect:

\* A. Replace the bulb:

While a failing bulb may eventually cause issues, it would not typically result in a strange smell or repeated shutdowns after a fixed period. Bulb issues usually manifest as dim or flickering images.

\* B. Check the projector configuration:

Configuration settings, such as resolution or input options, would not cause overheating or shutdowns. This option does not address the described symptoms.

\* D. Adjust the gamma settings:

Gamma settings affect display brightness and contrast but have no impact on overheating or strange smells.

Practical Example:

Dust accumulation in projectors is a common issue, especially in environments with poor air circulation. A clogged filter causes restricted airflow, leading to overheating and automatic shutdowns to protect internal components. Cleaning the filter typically resolves this issue.

CompTIA A+ Exam Objective Alignment:

Objective 5.5: Troubleshoot common video, projector, and display issues.

**NEW QUESTION 89**

- (Topic 1)

A technician wants to upgrade a computer to a new Windows version. The Windows Upgrade Advisor states that the computer is not compatible with the new Windows version due to a lack of TPM 2.0 support. Which of the following should the technician do next?

- A. Enable the module in the UEFI BIOS.
- B. Install an HSM in the computer.
- C. Perform a clean Install of the new Windows version.
- D. Implement BitLocker on the computer.

**Answer: A**

**Explanation:**

TPM 2.0 (Trusted Platform Module) is often disabled by default in the UEFI BIOS. Enabling it is necessary to meet the requirements for certain Windows installations, including Windows 11.

Why Not B (Install an HSM): A Hardware Security Module (HSM) is a separate device used for cryptographic functions and is not related to TPM on the motherboard.

Why Not C (Perform a clean install): A clean installation will not bypass the TPM 2.0 requirement.

Why Not D (Implement BitLocker): BitLocker requires TPM but does not resolve its absence or lack of activation.

CompTIA A+ Exam Reference: Core 1 (220-1201), Section 3.4, BIOS/UEFI configuration.

**NEW QUESTION 94**

- (Topic 1)

A technician receives a tablet that looks like it has a bulge inside. The bulge is pushing the screen away from the backplate. The tablet still turns on when it is plugged in, but the screen looks damaged and turns off when unplugged. Which of the following is the most likely cause of this issue?

- A. Malfunctioning power supply
- B. Damaged charge port
- C. Deprecated battery
- D. Broken screen

**Answer: C**

**Explanation:**

Comprehensive and Detailed In-Depth Explanation:

A bulging tablet casing is a classic sign of a swollen lithium-ion battery, often caused by age, overheating, or overcharging. This is a dangerous condition, as swollen batteries can rupture or catch fire. It also explains why the tablet only works when plugged in — the battery is no longer holding a charge.

? Option A: Power supply issues wouldn't cause physical bulging.

? Option B: A bad charge port wouldn't cause screen damage or physical distortion.

? Option D: A broken screen could cause display issues, but not the bulging chassis. CompTIA A+ Core 1 Exam Objective Reference:

? Objective 1.4: Given a scenario, configure settings and use cases for laptops and mobile devices.

=====

**NEW QUESTION 95**

- (Topic 1)

Which of the following printing initiatives would be best to accomplish environmentally friendly objectives?

- A. Requiring user authentication for printing
- B. Locking down printing to only certain individuals
- C. Modifying duplex settings to double-sided
- D. Changing the print quality settings to best

**Answer:** C

**Explanation:**

Comprehensive and Detailed Step-by-Step Explanation: Modifying duplex settings to double-sided:

Printing on both sides of the paper (duplex printing) reduces paper usage, making it one of the most effective environmentally friendly printing initiatives.

It directly minimizes waste and supports sustainability goals in the workplace. Incorrect Options:

\* A. Requiring user authentication for printing: While this can reduce unnecessary or unauthorized printing, it does not directly address environmental objectives like saving resources.

\* B. Locking down printing to only certain individuals: Limiting access may reduce printing overall, but it does not actively contribute to environmentally friendly practices like duplex printing.

\* D. Changing the print quality settings to best: Using the "best" print quality increases toner or ink usage, which is counterproductive to environmentally friendly objectives.

Key Takeaway:

Modifying duplex settings to enable double-sided printing is the best initiative to achieve environmentally friendly goals by reducing paper consumption.

Reference: CompTIA A+ Core 1 Exam Objectives (220-1201), Domain 3.8 – Implementing best practices for environmental impact.

**NEW QUESTION 96**

- (Topic 1)

While reviewing options in the BIOS/UEFI settings page to fix a laptop issue, a support technician notices an option to clear existing TPM keys. Which of the following would most likely happen if the TPM is cleared?

- A. Encrypted hard drives would probably not be accessible.
- B. All security certificates would need to be reinstalled from trusted roots.
- C. The device would need to be reenrolled in the MDM platform
- D. The laptop would need to be registered to the domain as a new client.

**Answer:** A

**Explanation:**

The Trusted Platform Module (TPM) is a hardware-based security feature used to store cryptographic keys, such as those used for encryption, authentication, or device identification. It plays a critical role in ensuring secure operations for encrypted drives, BitLocker, and secure boot processes. Clearing TPM keys involves wiping all stored cryptographic data, which can lead to several consequences depending on what the TPM was being used for. Let's break it down:

Correct Answer A. Encrypted hard drives would probably not be accessible. Encrypted hard drives, such as those secured with BitLocker encryption, rely on the cryptographic keys stored in the TPM to unlock data.

Clearing the TPM will erase these keys, making it impossible for the encrypted drive to decrypt its contents unless a recovery key (separate from the TPM) is available. Without this recovery key, the data will likely become inaccessible.

CompTIA A+ Core 1 Exam Objective Reference: This falls under Objective 3.5, which covers understanding BIOS/UEFI configurations, TPM functions, and securing devices.

Why the Other Options Are Incorrect:

\* B. All security certificates would need to be reinstalled from trusted roots.

Clearing the TPM does not erase security certificates stored in the operating system or other areas. Certificates are generally managed by the OS or specific applications, not the TPM. Clearing the TPM only affects cryptographic keys and data stored in the TPM chip, so this is incorrect.

\* C. The device would need to be reenrolled in the MDM platform.

Mobile Device Management (MDM) enrollment typically does not rely on the TPM. While certain enterprise security configurations may involve the TPM, clearing it does not inherently trigger MDM reenrollment unless specifically tied to the MDM configuration.

\* D. The laptop would need to be registered to the domain as a new client.

While domain registrations may sometimes use TPM for authentication or secure operations, clearing the TPM alone does not require re-registering the device to the domain. The domain registration and authentication process rely more on system-level credentials than the TPM itself.

Practical Example:

A user enables BitLocker on their laptop, which relies on the TPM to store the encryption key. Later, if they clear the TPM via BIOS/UEFI without saving the BitLocker recovery key separately, they will not be able to unlock the hard drive, leading to data loss unless the recovery key is available. This is a common issue when technicians or users inadvertently clear the TPM without understanding its role in encryption.

CompTIA A+ Exam Objective Alignment:

Objective 3.5: Given a scenario, install and configure laptop hardware and components, including UEFI/BIOS security settings (TPM, secure boot, etc.).

This question tests understanding of TPM functionality, encryption technologies, and secure device configurations.

**NEW QUESTION 100**

- (Topic 1)

A computer displays an error message indicating there is insufficient storage when installing applications. The user reports slow application load times. Which of the following replacement components would best resolve this issue?

- A. SSD
- B. USB
- C. HDD
- D. RAM

**Answer:** A

**Explanation:**

Comprehensive and Detailed In-Depth Explanation:

Upgrading to a solid-state drive (SSD) provides more storage space and faster read/write speeds, which resolves both the "insufficient storage" error and slow application loads.

? Option B (USB): Not intended for permanent application storage or performance improvements.

? Option C (HDD): Could solve storage capacity but would not improve speed.

? Option D (RAM): Affects multitasking and memory-intensive tasks, not storage capacity directly.

CompTIA A+ Core 1 Exam Objective Reference:

? Objective 3.5: Given a scenario, troubleshoot problems related to storage devices.

### NEW QUESTION 105

- (Topic 1)

A user is receiving many unsolicited emails. Which of the following controls can be configured to best reduce these types of emails?

- A. Load balancer
- B. Spam gateway
- C. Mail forwarding
- D. Proxy servers

**Answer: B**

#### Explanation:

A spam gateway filters unsolicited emails at the server level, significantly reducing spam before it reaches user inboxes.

Why Not A (Load balancer): Load balancers distribute traffic but don't filter spam. Why Not C (Mail forwarding): Forwarding doesn't filter spam.

Why Not D (Proxy servers): Proxies control web traffic, not email filtering.

CompTIA A+ Exam Reference: Core 2 (220-1102), Section 2.10, email security controls.

### NEW QUESTION 106

- (Topic 1)

Which of the following would prevent a virtual machine from communicating with any endpoints on a network or the internet?

- A. VDI
- B. Private cloud
- C. Sandbox
- D. Type 1 hypervisor

**Answer: C**

#### Explanation:

Comprehensive and Detailed In-Depth Explanation:

A sandbox is an isolated virtual environment used to test or run applications securely without risk to the host or network. It prevents the VM from communicating with external systems, making it ideal for testing malware or suspicious software.

? Option A (VDI): Virtual Desktop Infrastructure allows network communication; it does not restrict it.

? Option B (Private cloud): Refers to a cloud deployment model, not a communication barrier.

? Option D (Type 1 hypervisor): Runs VMs directly on hardware and does not inherently block communication.

CompTIA A+ Core 1 Exam Objective Reference:

? Objective 4.1: Compare and contrast cloud computing concepts.

=====

### NEW QUESTION 111

- (Topic 1)

A user wants to print files from an overseas office using a shared network folder. The user's laptop has no public-facing internet connectivity. Which of the following can be used to print from the shared network folder?

- A. ADF
- B. USB
- C. PCL
- D. SMB

**Answer: D**

#### Explanation:

Comprehensive and Detailed In-Depth Explanation:

SMB (Server Message Block) is a protocol used to access files and printers over a network, including across shared network folders. It enables the user to access and print files stored remotely on a shared directory.

? Option A (ADF): Automatic Document Feeder — hardware, not a network protocol.

? Option B (USB): Used for direct physical connections, not for printing over networks.

? Option C (PCL): Printer Command Language — relates to printer drivers, not file sharing or access.

CompTIA A+ Core 1 Exam Objective Reference:

? Objective 3.4: Given a scenario, install and configure printers.

### NEW QUESTION 113

- (Topic 1)

A help desk technician needs to work on a high-volume printer. Users have reported occasional paper jams and smudges appearing on printed documents. Which of the following steps should the technician do next to address these issues?

- A. Perform a full factory reset.
- B. Check and clean the rollers.
- C. Change all the ink or toner cartridges.
- D. Replace the fuser.

**Answer: B**

#### Explanation:

Comprehensive and Detailed In-Depth Explanation:

Paper jams and smudging in high-volume printers are often caused by dirty or worn rollers. Rollers are responsible for feeding the paper through the printer. Over time, they accumulate dust, toner residue, or wear out, resulting in misfeeds or jams. Cleaning or replacing them typically resolves this issue.

? Option A (Factory reset): A full reset does not directly address mechanical issues

like dirty rollers or smudging. It's a last resort and more relevant to configuration or software-related issues.

? Option C (Change toner cartridges): While toner quality can affect print quality, it won't usually cause jams or widespread smudging unless the cartridge is leaking — which is less likely across multiple users.

? Option D (Replace the fuser): A damaged fuser could cause smudging, but this is typically after extensive use and is not the first thing to check. Fuser issues also usually present more persistent, uniform smudges.

CompTIA A+ Core 1 Exam Objective Reference:

? Objective 3.7: Given a scenario, troubleshoot common printer problems.

#### NEW QUESTION 118

- (Topic 1)

When installing a network printer, a technician needs to ensure the printer is available after a network is restarted. Which of the following should the technician set up on the printer to meet this requirement?

- A. Static IP address
- B. Private address
- C. Wi-Fi on the printer
- D. Dynamic addressing

**Answer:** A

#### Explanation:

Comprehensive and Detailed In-Depth Explanation:

Assigning a static IP address to a network printer ensures it always retains the same address, allowing users and print servers to consistently reach it even after a reboot or network refresh.

? Option B (Private address): Refers to address ranges (e.g., 192.168.x.x) — doesn't guarantee address persistence.

? Option C (Wi-Fi): Is a connection method, not a method of IP assignment.

? Option D (Dynamic addressing): Via DHCP, which can change over time unless reservations are made (less reliable).

CompTIA A+ Core 1 Exam Objective Reference:

? Objective 3.4: Given a scenario, install and configure printers.

#### NEW QUESTION 119

- (Topic 1)

A user reports that their desktop PC does not turn on. Which of the following components would most likely cause the issue?

- A. PSU
- B. GPU
- C. RAM
- D. CPU

**Answer:** A

#### Explanation:

Comprehensive and Detailed In-Depth Explanation:

If a desktop fails to power on entirely, the most probable cause is a faulty Power Supply Unit (PSU). If there are no lights, fans, or POST beeps, the PSU may have failed, cutting off all power to the motherboard and components.

? Option B (GPU): Could prevent video output, but the system would still power on and beep.

? Option C (RAM): Missing or faulty RAM would cause POST errors but not prevent startup entirely.

? Option D (CPU): A bad CPU may cause POST failure, but the system would usually at least power on.

CompTIA A+ Core 1 Exam Objective Reference:

? Objective 3.5: Given a scenario, troubleshoot problems related to motherboards, RAM, CPU, and power.

=====

#### NEW QUESTION 124

- (Topic 1)

A financial institution needs a secure way to protect encryption keys used for unlocking chips on its credit cards. Which of the following should the institution use?

- A. TLS
- B. AMD
- C. HSM
- D. ARM

**Answer:** C

#### Explanation:

A Hardware Security Module (HSM) securely manages cryptographic keys, including those used to protect credit card chips.

Why Not A (TLS): TLS secures data in transit, not encryption key storage. Why Not B (AMD): AMD refers to processors, not security modules.

Why Not D (ARM): ARM is a processor architecture, not a cryptographic security solution. CompTIA A+ Exam Reference: Core 2 (220-1102), Section 2.5, cryptographic hardware.

#### NEW QUESTION 129

- (Topic 1)

A user prints a job from a laser printer. The user wipes the page, and the words and images come off of it. The technician replaces the toner cartridge, but the issue persists. Which of the following components should the technician replace next?

- A. Fuser
- B. Drum
- C. Developer roller

D. Discharge lamp

**Answer:** A

**Explanation:**

Comprehensive and Detailed In-Depth Explanation:

In laser printers, the fuser unit is responsible for melting the toner onto the paper using heat and pressure. If the toner rubs off easily, it's a clear sign the fuser is failing or not heating properly. Replacing the fuser will ensure the toner bonds correctly to the paper.

? Option B (Drum): Transfers the image, but doesn't fuse the toner.

? Option C (Developer roller): Applies toner to the drum — wouldn't cause toner to rub off.

? Option D (Discharge lamp): Prepares the drum for a new image; not related to toner adhesion.

CompTIA A+ Core 1 Exam Objective Reference:

? Objective 3.7: Given a scenario, troubleshoot common printer problems.

=====

**NEW QUESTION 132**

- (Topic 1)

A company wants to save printing costs by restricting network printer use. The company implements a solution that requires employees to authenticate to the printer to release print jobs. Which of the following has the company implemented?

- A. Access control list
- B. Audit logging
- C. Badging
- D. Print server

**Answer:** C

**Explanation:**

Badging is a form of authentication that requires employees to use a badge or ID card to release print jobs. This solution reduces unnecessary printing by ensuring only authorized users print.

Why Not A (Access control list): While ACLs manage permissions, they are not used for physical authentication at printers.

Why Not B (Audit logging): Audit logs track actions but do not restrict printer access. Why Not D (Print server): A print server manages print jobs but doesn't enforce authentication.

CompTIA A+ Exam Reference: Core 2 (220-1102), Section 2.5, authentication mechanisms.

**NEW QUESTION 137**

- (Topic 1)

A small company wants the ability to print in full color but needs to pay a minimal initial purchase price for the printer. Which of the following is the best option?

- A. Thermal printer
- B. Inkjet printer
- C. Dot matrix printer
- D. Laser printer

**Answer:** B

**Explanation:**

Inkjet printers are the best choice for a small company seeking full-color printing with a minimal initial cost. While they have higher operating costs (due to ink), they are affordable and capable of high-quality color output.

Why Not A (Thermal printer): Thermal printers are not designed for color printing and are typically used for labels or receipts.

Why Not C (Dot matrix printer): Dot matrix printers are outdated, noisy, and do not support full-color printing.

Why Not D (Laser printer): Laser printers have lower running costs but a higher initial purchase price, especially for color models.

CompTIA A+ Exam Reference: Core 2 (220-1102), Section 4.6, printer types.

**NEW QUESTION 141**

- (Topic 1)

Which of the following can a user utilize to share their mobile phone connection with their laptop?

- A. IR
- B. NFC
- C. Wi-Fi Direct
- D. Tethering

**Answer:** D

**Explanation:**

Tethering refers to sharing a mobile phone's internet connection with another device, such as a laptop, either through USB, Bluetooth, or Wi-Fi. Tethering effectively turns the mobile phone into a personal hotspot for internet access.

Option A (IR): Incorrect. Infrared (IR) is used for short-range communication, such as remote controls, but it does not support internet sharing.

Option B (NFC): Incorrect. Near-field communication (NFC) is used for close-proximity data transfer, not for internet sharing.

Option C (Wi-Fi Direct): Incorrect. Wi-Fi Direct enables device-to-device communication but does not inherently provide internet sharing.

References:

CompTIA A+ Core 1 Objectives: 1.4 (Configure basic mobile-device network connectivity)

**NEW QUESTION 146**

HOTSPOT - (Topic 2)

A customer built a computer for gaming, sourcing individual components and then assembling the system. The OS starts up, but within a few minutes the machine locks up.

The customer brought the computer to a technician to diagnose the issue.

- A. Mastered
- B. Not Mastered

**Answer:** A

**Explanation:**

correct answer is "Overclocking" and "Reduce CPU Clock speed" CPU is at 4.5 Ghz when normal is 3.2 Ghz. Overclocking too much can cause freezes, and this is a gaming computer so the user probably took it too far. <http://blog.logicalincrements.com/2018/12/4-troubleshooting-tips-overclocking-pc/>

**NEW QUESTION 148**

SIMULATION - (Topic 2)

A third-party contractor recently installed a new switch, router, and cabling for a small corporate office. After the installation, users started experiencing issues connecting to resources over the network. INSTRUCTIONS

Click on each PC and server to review outputs. From the remediation section on the right, select an issue and solution for each device.

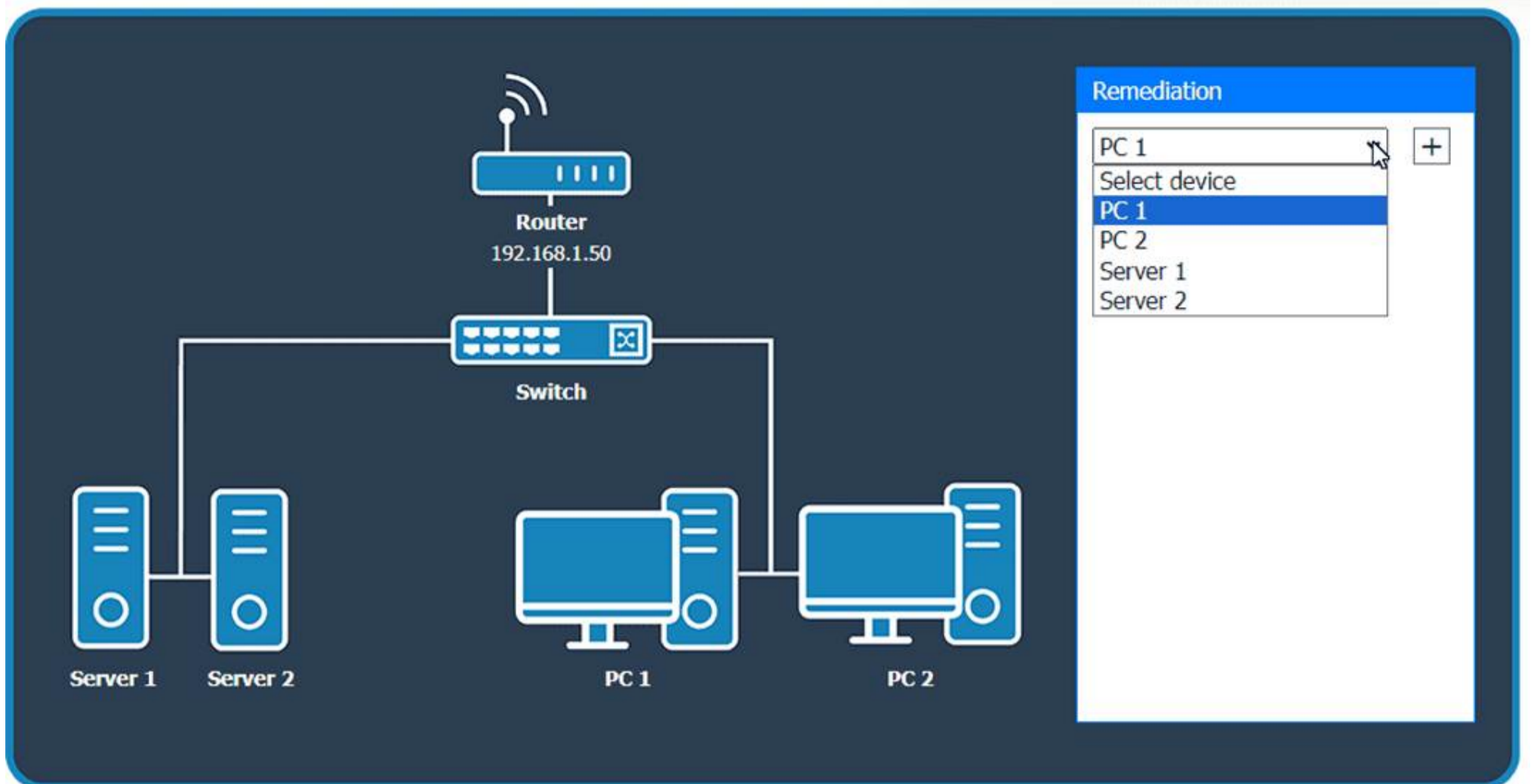

### PC 1

Command terminal IPv4 properties

Internet protocol version 4 (TCP/IPv4) properties

You can get IP settings assigned automatically if your network supports this capability. Otherwise, you need to ask your network administrator for the appropriate IP settings.

- Obtain an IP address automatically
- Use the following IP address:
 

IP address:	192.168.1.1
Subnet mask:	255.255.255.0
Default gateway:	192.168.1.50
- Obtain DNS server address automatically
- Use the following DNS server addresses:
 

Preferred DNS server:	192.168.1.1
Alternate DNS server:	192.168.1.50
- Validate settings upon exit

Advanced...

PC 1



Command terminal

IPv4 properties

```
ipconfig /all
```

Windows IP Configuration

```
Host Name . . . . . : PC1
Primary Dns Suffix . . . . . :
Node Type . . . . . : Peer-Peer
IP Routing Enabled. . . . . : No
WINS Proxy Enabled. . . . . : No
DNS Suffix Search List. . . . . : corp.lan
```

Ethernet adapter Ethernet 1:

```
Connection-specific DNS Suffix . : corp.lan
Description . . . . . : Realtek USB GbE Family Controller
Physical Address. . . . . : E1:7C:5C:D4:57:79
DHCP Enabled. . . . . : No
Autoconfiguration Enabled . . . . : No
IPv4 Address. . . . . : 192.168.1.1 (Preferred)
Subnet Mask . . . . . : 255.255.255.0
Default Gateway . . . . . : 192.168.1.50
```

PC 1



Command terminal

IPv4 properties

```
Host Name . . . . . : PC1
Primary Dns Suffix . . . . . :
Node Type . . . . . : Peer-Peer
IP Routing Enabled. . . . . : No
WINS Proxy Enabled. . . . . : No
DNS Suffix Search List. . . . . : corp.lan
```

Ethernet adapter Ethernet 1:

```
Connection-specific DNS Suffix . : corp.lan
Description . . . . . : Realtek USB GbE Family Controller
Physical Address. . . . . : E1:7C:5C:D4:57:79
DHCP Enabled. . . . . : No
Autoconfiguration Enabled . . . . : No
IPv4 Address. . . . . : 192.168.1.1 (Preferred)
Subnet Mask . . . . . : 255.255.255.0
Default Gateway . . . . . : 192.168.1.50
DNS Servers . . . . . : 192.168.1.1
                        192.168.1.50
NetBIOS over Tcpiip. . . . . : Enabled
```

PC 2



Command terminal

IPv4 properties

```

Node Type . . . . . : Peer-Peer
IP Routing Enabled. . . . . : No
WINS Proxy Enabled. . . . . : No
DNS Suffix Search List. . . . . : corp.lan

Ethernet adapter Ethernet 1:

    Connection-specific DNS Suffix . : corp.lan
    Description . . . . . : Realtek USB GbE Family Controller
    Physical Address. . . . . : 36:9E:94:F0:59:83
    DHCP Enabled. . . . . : Yes
    Autoconfiguration Enabled . . . . : Yes
    IPv4 Address. . . . . : 192.168.1.12 (Preferred)
    Subnet Mask . . . . . : 255.255.255.0
    Lease Obtained. . . . . : August 28, 2023 9:07:46 AM
    Lease Expires . . . . . : August 29, 2023 9:07:46 AM
    Default Gateway . . . . . : 192.168.1.50
    DHCP Server . . . . . : 192.168.1.1
    DNS Servers . . . . . : 192.168.1.1
                             192.168.1.50
NetBIOS over Tcpip . . . . . : Enabled
    
```

PC 2



Command terminal

IPv4 properties

### Internet protocol version 4 (TCP/IPv4) properties

You can get IP settings assigned automatically if your network supports this capability. Otherwise, you need to ask your network administrator for the appropriate IP settings.

Obtain an IP address automatically

Use the following IP address:

IP address:	192.168.1.2
Subnet mask:	255.255.0.0
Default gateway:	192.168.1.50

Obtain DNS server address automatically

Use the following DNS server addresses:

Preferred DNS server:	192.168.1.1
Alternate DNS server:	192.168.1.50

Validate settings upon exit

Advanced...

## Server 1



Command terminal

IPv4 properties

```
Host Name . . . . . : Server1
Primary Dns Suffix . . . . . :
Node Type . . . . . : Peer-Peer
IP Routing Enabled. . . . . : No
WINS Proxy Enabled. . . . . : No
DNS Suffix Search List. . . . . : corp.lan
```

Ethernet adapter Ethernet 1:

```
Connection-specific DNS Suffix . : corp.lan
Description . . . . . : Realtek USB GbE Family Controller
Physical Address. . . . . : B2:9F:BB:2C:21:74
DHCP Enabled. . . . . : No
Autoconfiguration Enabled . . . . : No
IPv4 Address. . . . . : 192.168.1.1 (Preferred)
Subnet Mask . . . . . : 255.255.255.255
Default Gateway . . . . . : 192.168.1.50
DNS Servers . . . . . : 192.168.1.1
                        192.168.1.50
NetBIOS over Tcpi . . . . . : Enabled
```

Server 1



Command terminal

IPv4 properties

Internet protocol version 4 (TCP/IPv4) properties

You can get IP settings assigned automatically if your network supports this capability. Otherwise, you need to ask your network administrator for the appropriate IP settings.

Obtain an IP address automatically

Use the following IP address:

IP address:	192.168.1.1
Subnet mask:	255.255.255.0
Default gateway:	192.168.1.50

Obtain DNS server address automatically

Use the following DNS server addresses:

Preferred DNS server:	192.168.1.1
Alternate DNS server:	192.168.1.50

Validate settings upon exit

Advanced...

## Server 2



### Command terminal IPv4 properties

```

Host Name . . . . . : Server2
Primary Dns Suffix . . . . . :
Node Type . . . . . : Peer-Peer
IP Routing Enabled. . . . . : No
WINS Proxy Enabled. . . . . : No
DNS Suffix Search List. . . . . : corp.lan

Ethernet adapter Ethernet 1:

    Connection-specific DNS Suffix . : corp.lan
    Description . . . . . : Realtek USB GbE Family Controller
    Physical Address. . . . . : AC:5D:46:89:72:6D
    DHCP Enabled. . . . . : No
    Autoconfiguration Enabled . . . . : No
    IPv4 Address. . . . . : 192.168.1.2 (Preferred)
    Subnet Mask . . . . . : 255.255.255.0
    Default Gateway . . . . . : 192.168.1.5
    DNS Servers . . . . . : 192.168.1.1
                           192.168.1.50
    NetBIOS over Tcpi. . . . . : Enabled
    
```

Server 2
✕

Command terminal

IPv4 properties

**Internet protocol version 4 (TCP/IPv4) properties**

You can get IP settings assigned automatically if your network supports this capability. Otherwise, you need to ask your network administrator for the appropriate IP settings.

Obtain an IP address automatically

Use the following IP address:

IP address:	192.168.1.2
Subnet mask:	255.255.255.0
Default gateway:	192.168.1.50

Obtain DNS server address automatically

Use the following DNS server addresses:

Preferred DNS server:	192.168.1.1
Alternate DNS server:	192.168.1.50

Validate settings upon exit

Advanced...

- A. Mastered
- B. Not Mastered

**Answer:** A

**Explanation:**

Looking at the network configurations and outputs from both PCs and servers, here are the possible issues and solutions:

\* 1. PC 1

Issue: The IP address for PC1 is 192.168.1.1, which conflicts with Server 1 (which also uses 192.168.1.1).

Solution: Change the IP address on PC1 to a unique one within the range, like 192.168.1.3.

\* 2. PC 2

Issue: PC 2 is configured with 192.168.1.2, which conflicts with Server 2 that has the same IP address.

Solution: Update the IP address on PC 2 to something unique, like 192.168.1.4.

\* 3. Server 1

Issue: The IP address for Server 1 is 192.168.1.1, which conflicts with PC1.

Solution: Since Server 1 and PC1 are using the same IP address, change one of them. For Server 1, you could change the IP address to 192.168.1.5.

\* 4. Server 2

Issue: Server 2 is using the IP address 192.168.1.2, which conflicts with PC2. Solution: Update Server 2 to use a different IP address, such as 192.168.1.6.

General Remediation:

The primary problem here is overlapping IP addresses, leading to connectivity issues. Each device on the network must have a unique IP address. After making these changes, ensure that all devices can communicate properly by testing the connection between devices and verifying they can access shared resources.

**NEW QUESTION 150**

HOTSPOT - (Topic 2)

A customer has contacted you about building two new desktops. The first desktop will be a gaming workstation. The customer requirements include:

- Playing the newest games at a high frame rate
- Fast game load times
- Enough storage to have several games installed at once
- High-end audio
- No concern about cost
- Running the current Windows OS

The second workstation will be a family workstation. The requirements include: Capability for word processing, videoconferencing, and basic web surfing Minimal cost, as long as it meets the requirements Running the current Windows OS

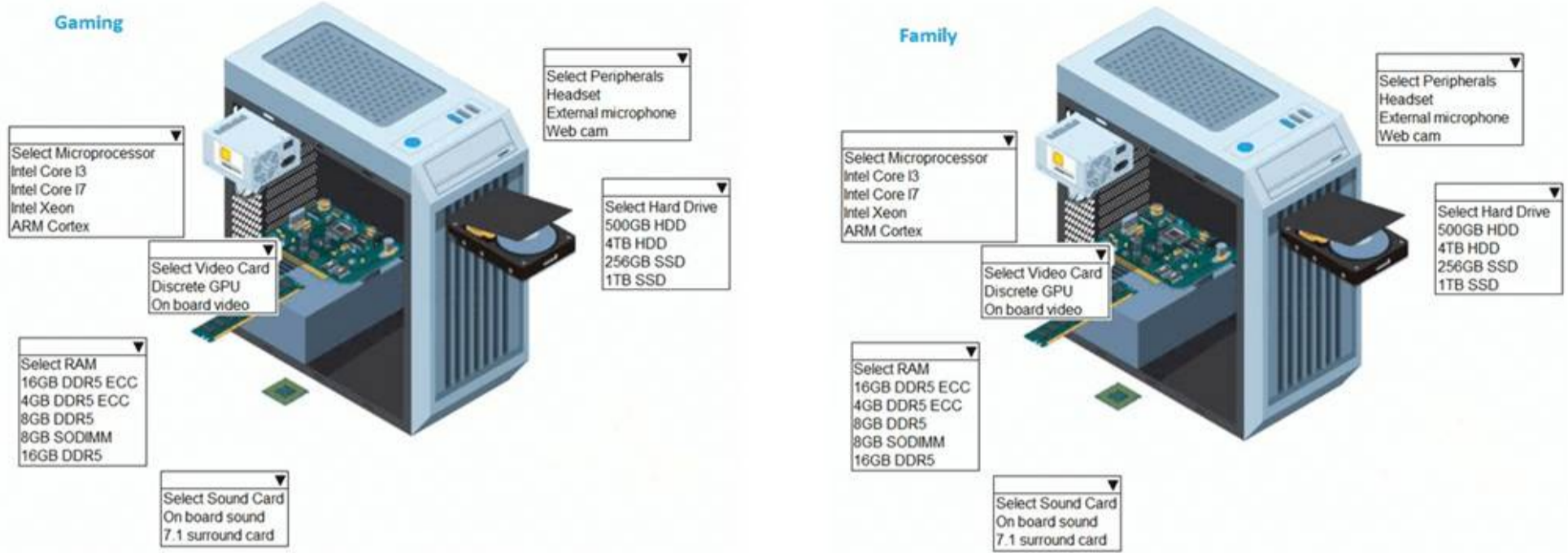

- A. Mastered
- B. Not Mastered

**Answer: A**

**Explanation:**

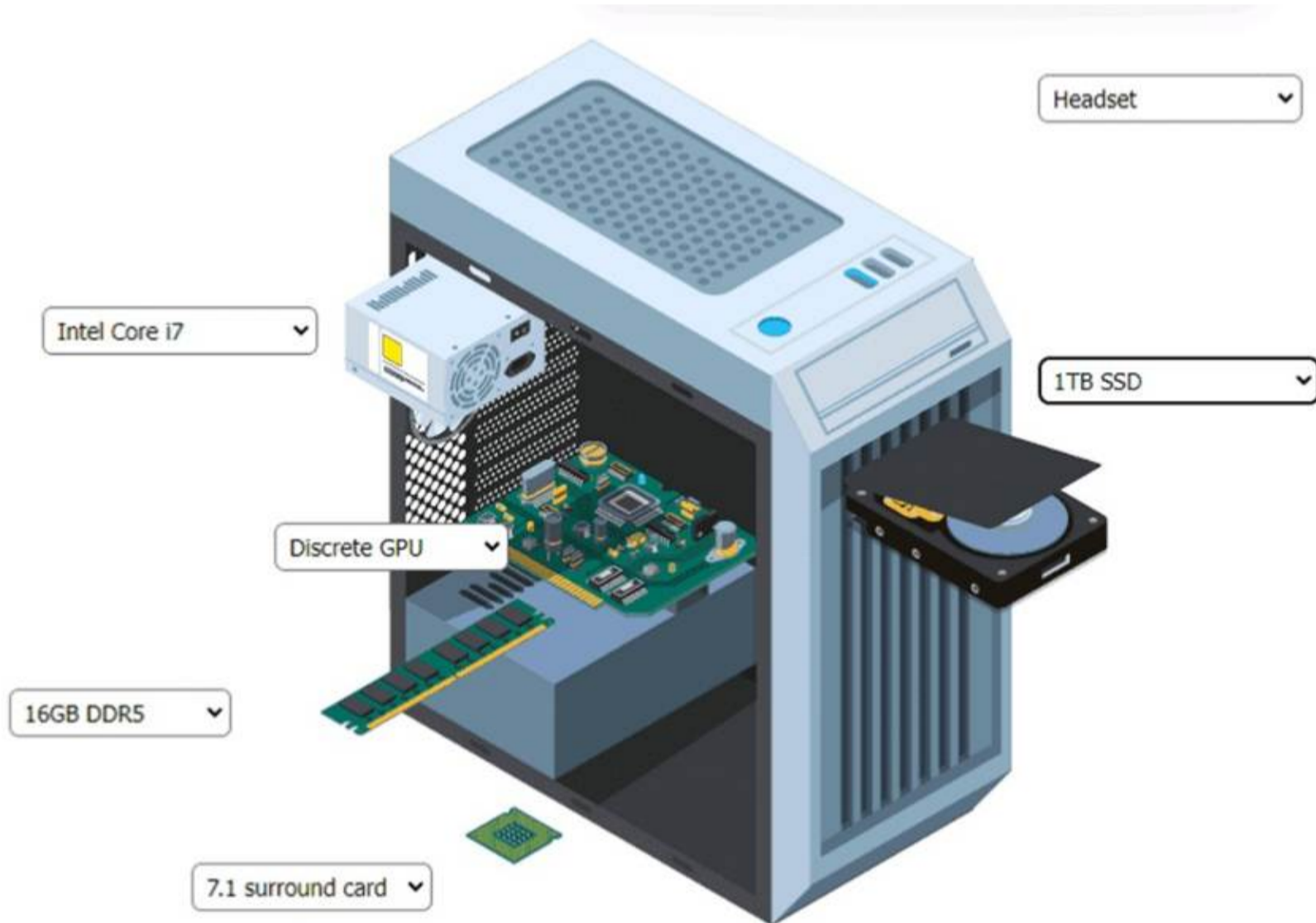

A computer tower with a hard drive and a hard drive AI-generated content may be incorrect.

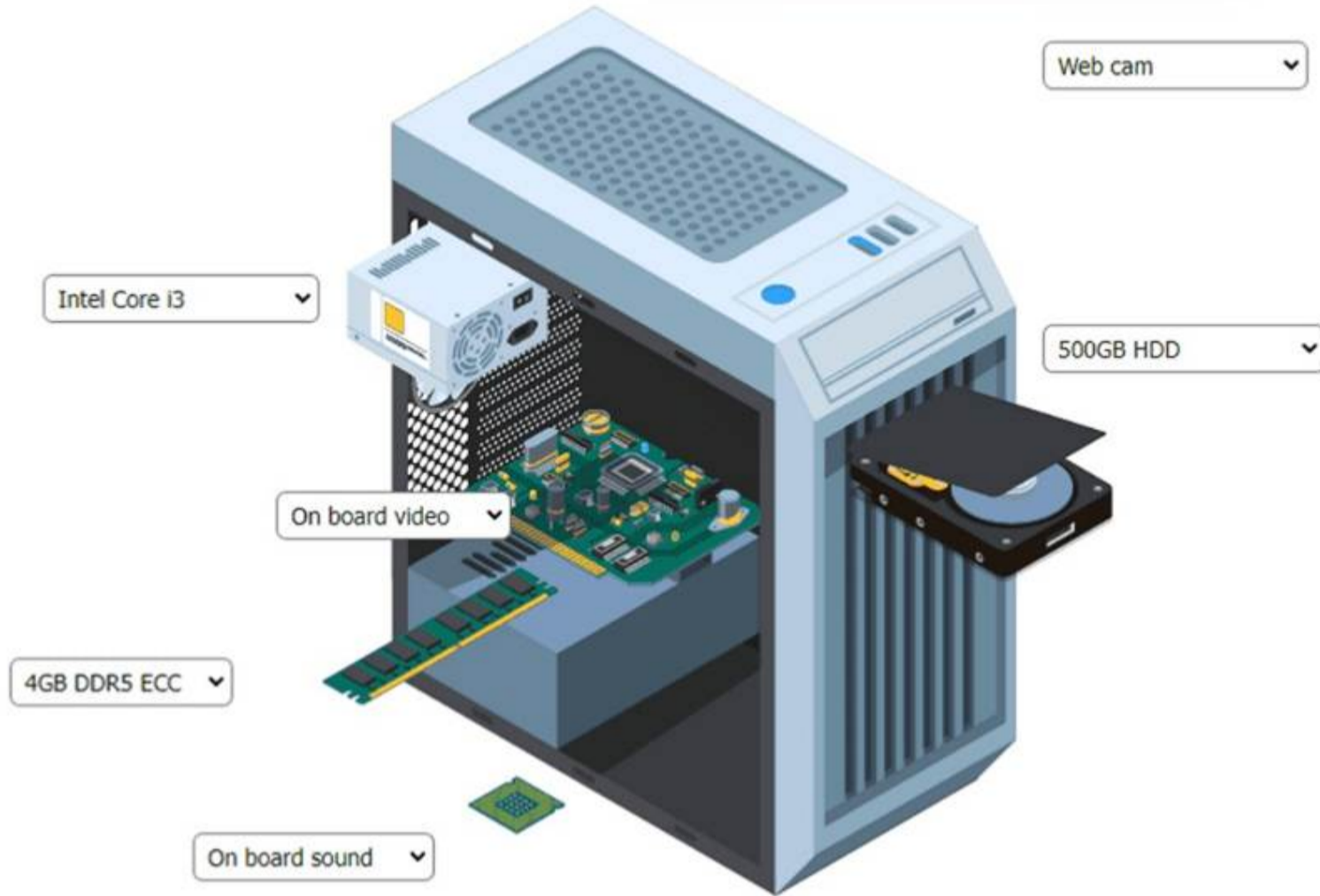

A computer tower with a computer and a hard drive AI-generated content may be incorrect.

**NEW QUESTION 154**

.....

## **Thank You for Trying Our Product**

### **We offer two products:**

1st - We have Practice Tests Software with Actual Exam Questions

2nd - Questions and Answers in PDF Format

### **220-1201 Practice Exam Features:**

- \* 220-1201 Questions and Answers Updated Frequently
- \* 220-1201 Practice Questions Verified by Expert Senior Certified Staff
- \* 220-1201 Most Realistic Questions that Guarantee you a Pass on Your First Try
- \* 220-1201 Practice Test Questions in Multiple Choice Formats and Updates for 1 Year

**100% Actual & Verified — Instant Download, Please Click**  
[Order The 220-1201 Practice Test Here](#)